

## Cleaning guide

To always get the best performance from the Dyson Airblade Wash+Dry hand dryer, it's important to regularly clean it and check for blockages.

### Clean the sensors

Wipe sensors using a soft cloth and non-abrasive cleaner then place cleaning cap over sensors to prevent activation.

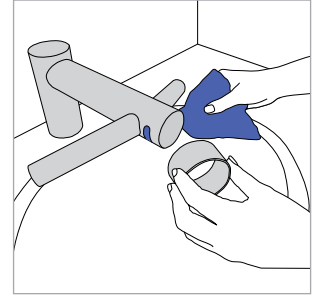

### Clean the machine

Clean all tap surfaces, sink, mirror and any walls or counter tops. When complete REMEMBER to remove cleaning cap.

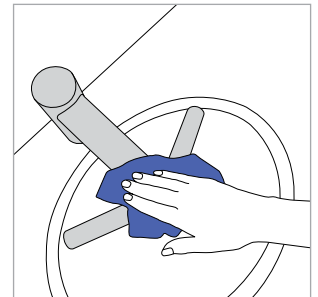

### Clean and check for blockages

REGULARLY clean air inlets on base of motor bucket (under sink). Ensure plughole in sink is free from blockages so water can drain freely.

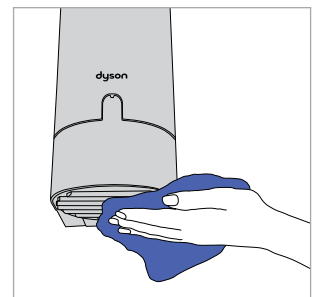

### What to use to clean the Dyson Airblade Wash+Dry hand dryer

Important: Do not pressure wash the Dyson Airblade Wash+Dry hand dryer.

Types of cleaning	How to clean	Do not use
Routine cleaning of light soiling and fingerprints.	A mild detergent applied with a lint-free cloth. Remove detergent residue with a damp cloth and tap water.	Solvent/oil-based mixes Alkali-bleach mixes
Stubborn marks and stains, oil and grease marks.	A mild detergent, alcohol or Quaternary ammonium solution, diluted to the manufacturer's guidelines. Remove detergent residue with a damp cloth.	Foaming ingredients Bleach or abrasive cleaners
Water marks.	Water marks can be avoided by drying with a dry lint-free cloth.	

### Servicing and support

For more information:  
[ask@dyson.in](mailto:ask@dyson.in)  
[www.Dyson.in](http://www.Dyson.in)

For further information about Water supply cleanliness and bacteria growth, please refer to the Owner's manual.